

DOUBLEWAL[®]

Interlocking Precast Modular Wall

- *Fewer Picks*
- *Less Weight*
- *Easier to Backfill*
- *No Footing Required*
- *Faster Erection*
- *Many Surface Treatments Available*



United Concrete Products, Inc.
173 Church St. • Yalesville, CT 06492
203-269-3119 or Fax 203-265-4941
www.doublewal.com • www.unitedconcrete.com

We have millions of square feet of
Doublewal in place

DOUBLEWAL[®]

Technical Information

One of the primary reasons for the economy of the Doublewal System is the ease with which it is erected.

Units arrive at the job site ready for installation directly from the trailer. A crane or backhoe equipped with a Doublewal lifting sling provides safe and speedy erection.

In setting the base course, each module is checked to assure proper line and grade. The modules are filled with pervious fill and consolidated.

The setting and backfilling cycle continues until the wall is complete. In certain applications, precast traffic barriers or parapets are used.

With a small crew, under favorable conditions, installation rates of up to 2,000 square feet per day may be expected.

Notes

Modules are typically 4 feet high by 8 feet in length. Units 2 feet high are available for the top course and units 6 feet high are available for the bottom.

The parapet can be manufactured from 2 feet to 7 feet high, typically in 12 and 16 foot lengths and tapered to follow grade.

Parapets are available in either the standard or the traffic barrier configuration.

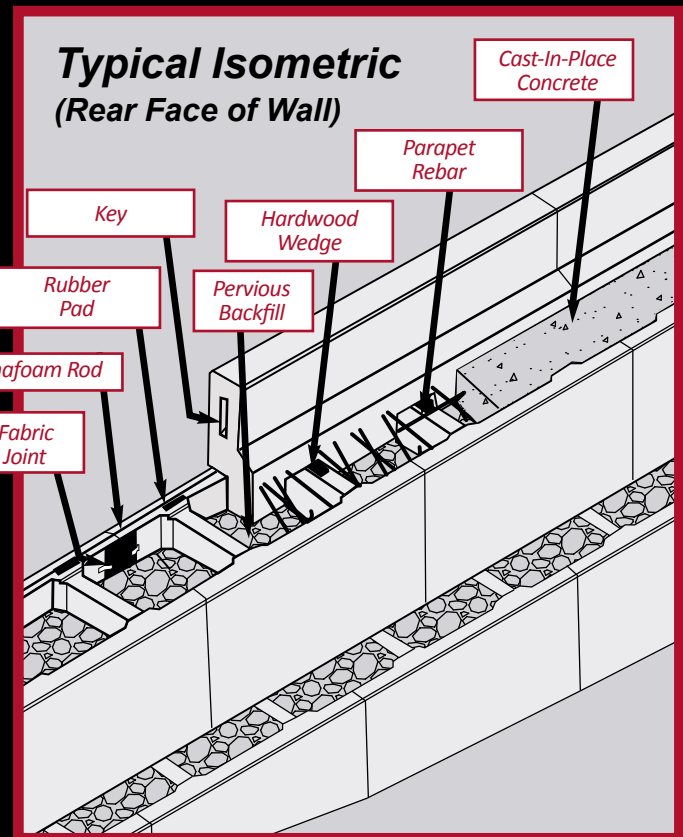
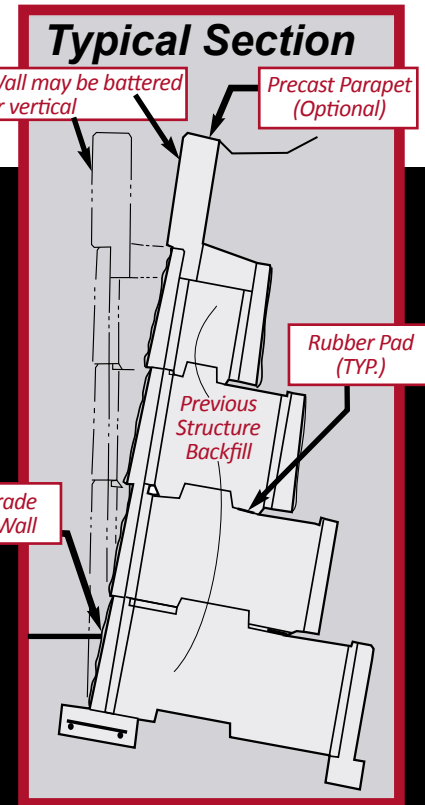

Doublewal Module Weights - 8 Feet Long

| | Width in Feet | 4 | 6 | 8 | 10 | 12 | 14 | 16 | 18 | 20 |
|-------------|------------------------|-------|-------|-------|-------|-------|-------|-------|-------|-------|
| 2 Feet High | Concrete Weight in lbs | 3551 | 4178 | 4619 | - | - | - | - | - | - |
| 4 Feet High | Concrete Weight in lbs | 7114 | 8387 | 9238 | 10802 | 15702 | 17123 | 18951 | 20454 | 22020 |
| 6 Feet High | Concrete Weight in lbs | 11287 | 13171 | 14194 | 16266 | 22996 | 25039 | 27310 | 29336 | - |